

По вопросам продаж и поддержки обращайтесь:

**Алматы** (7273)495-231  
**Ангарск** (3955)60-70-56  
**Архангельск** (8182)63-90-72  
**Астрахань** (8512)99-46-04  
**Барнаул** (3852)73-04-60  
**Белгород** (4722)40-23-64  
**Благовещенск** (4162)22-76-07  
**Брянск** (4832)59-03-52  
**Владивосток** (423)249-28-31  
**Владикавказ** (8672)28-90-48  
**Владимир** (4922)49-43-18  
**Волгоград** (844)278-03-48  
**Вологда** (8172)26-41-59  
**Воронеж** (473)204-51-73  
**Екатеринбург** (343)384-55-89  
**Иваново** (4932)77-34-06  
**Ижевск** (3412)26-03-58  
**Иркутск** (395)279-98-46  
**Казань** (843)206-01-48

**Калининград** (4012)72-03-81  
**Калуга** (4842)92-23-67  
**Кемерово** (3842)65-04-62  
**Киров** (8332)68-02-04  
**Коломна** (4966)23-41-49  
**Кострома** (4942)77-07-48  
**Краснодар** (861)203-40-90  
**Красноярск** (391)204-63-61  
**Курган** (3522)50-90-47  
**Курск** (4712)77-13-04  
**Липецк** (4742)52-20-81  
**Магнитогорск** (3519)55-03-13  
**Москва** (495)268-04-70  
**Мурманск** (8152)59-64-93  
**Набережные Челны** (8552)20-53-41  
**Нижний Новгород** (831)429-08-12  
**Новокузнецк** (3843)20-46-81  
**Новосибирск** (383)227-86-73  
**Ноябрьск**(3496)41-32-12

**Омск** (3812)21-46-40  
**Орел** (4862)44-53-42  
**Оренбург** (3532)37-68-04  
**Пенза** (8412)22-31-16  
**Пермь** (342)205-81-47  
**Петрозаводск** (8142)55-98-37  
**Псков** (8112)59-10-37  
**Ростов-на-Дону** (863)308-18-15  
**Рязань** (4912)46-61-64  
**Самара** (846)206-03-16  
**Санкт-Петербург** (812)309-46-40  
**Саранск** (8342)22-96-24  
**Саратов** (845)249-38-78  
**Севастополь** (8692)22-31-93  
**Симферополь** (3652)67-13-56  
**Смоленск** (4812)29-41-54  
**Сочи** (862)225-72-31  
**Ставрополь** (8652)20-65-13  
**Сургут** (3462)77-98-35

**Сыктывкар** (8212)25-95-17  
**Тамбов** (4752)50-40-97  
**Тверь** (4822)63-31-35  
**Тольятти** (8482)63-91-07  
**Томск** (3822)98-41-53  
**Тула** (4872)33-79-87  
**Тюмень** (3452)66-21-18  
**Улан-Удэ** (3012)59-97-51  
**Ульяновск** (8422)24-23-59  
**Уфа** (347)229-48-12  
**Хабаровск** (4212)92-98-04  
**Чебоксары** (8352)28-53-07  
**Челябинск** (351)202-03-61  
**Череповец** (8202)49-02-64  
**Чита** (3022)38-34-83  
**Якутск** (4112)23-90-97  
**Ярославль** (4852)69-52-93

**Россия** +7(495)268-04-70

**Казахстан** +7(7172)727-132

**Киргизия** +996(312)96-26-47

**omc@nt-rt.ru || www.omca.nt-rt.ru**

## ТЕХНИЧЕСКИЕ ХАРАКТЕРИСТИКИ НА ОПЦИИ ДЛЯ СТАНКОВ



# ROTATING COUNTERS LIVE CENTERS

An advanced technical conception with simple and solid design, and aims at the most requested conventional shapes.

The body is in special case-hardened, tempered and ground steel while the shaft is in tool steel, through-hardened and therefore grindable several times.

Thanks to the resistant section of the shaft, the accurately dimensioned bearings and the compact headstock, the tailstocks of the series **CR** they are the most suitable for withstanding considerable radial and axial loads.

The rear end of the shaft is supported by needle bearings.

The considerable shaft length ensures vibration-free operation.

The tailstock is protected against chips, water and dust.

The tailstock series **CR150, CR200, CR250** with their many accessories, all interchangeable, they are universal tailstocks suitable for roughing and finishing.

A technically highly developed design with all the conventional shapes of center points. The housing is of drop-forged high grade material, thus guaranteeing a uniform structure having maximum stability and load capacity.

The fully hardened body increases the serviceable life considerably.

The center is made of high quality tool-steel and is penetration-hardened and can be re-ground several times.

The remarkable diameter of the center, the widely sized rollers, the head comparatively short, make the series **CR** centers for remarkable radial and axial load. The back end of the center is supported by needle bearing.

A special sealing ring protects the bearing from coolant and dirt.

The live center series **CR150, CR200, CR250** with all the accessories supplied, are the Universall live center for fine turning and roughing.

## TAILSTOCK WITH NORMAL TIP *LIVE CENTER WITH STANDARD CENTER*

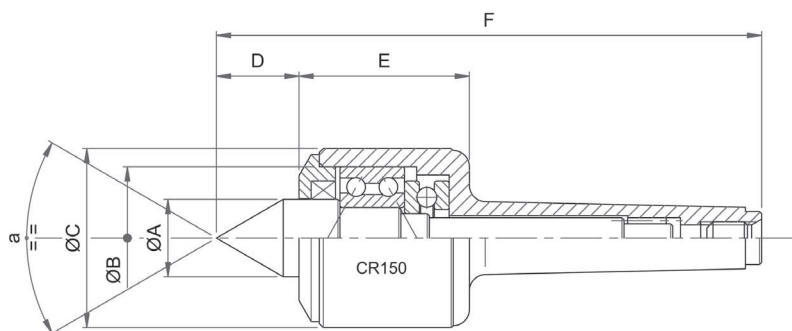

ARTICOLO - ORDER CODE		240/3	240/4	240/5	240/6
MODELLO - TYPE		CR150/3	CR150/4	CR150/5	CR150/6
CONO MORSE - MORSE TAPER		3	4	5	6
MAX ECCENTRICITA' - MAX RUNOUT	mm	0,005	0,005	0,005	0,005
PESO MAX PEZZO - COMPONENT MAX WEIGHT	Kg	100	250	500	1000
SPINTA ASSIALE MAX - MAX AXIAL WEIGHT	Kg	400	700	1000	1500
PESO CONTROPUNTA - LIVE CENTER WEIGHT	Kg	0,6	1,2	2,0	4,3
a		60°	60°	60°	60°
A	mm	20	25	32	43
B	mm	35	47	52	72
C	mm	44	58	62	88
D	mm	19	25	30	38
E	mm	43	55	56	71
F	mm	148	184,5	222	306,5

## TAILSTOCK WITH FEMALE CENTER DIN 332-60° LIVE CENTER WITH HOLLOW-POINT DIN 332-60°

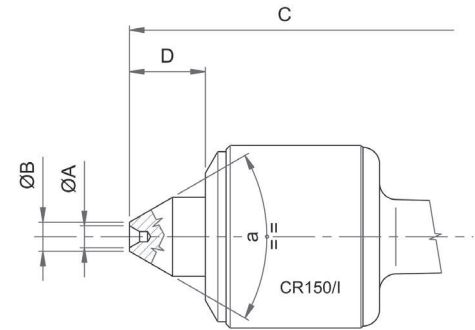

ARTICOLO - ORDER CODE		240/3/I	240/4/I	240/5/I	240/6/I
MODELLO - TYPE		CR150/3/I	CR150/4/I	CR150/5/I	CR150/6/I
CONO MORSE - MORSE TAPER		3	4	5	6
MAX ECCENTRICITA' - MAX RUNOUT	mm	0,005	0,005	0,005	0,005
PESO MAX PEZZO - COMPONENT MAX WEIGHT	Kg	80	200	400	800
SPINTA ASSIALE MAX - MAX AXIAL WEIGHT	Kg	400	700	1000	1500
a		60°	60°	60°	60°
A	mm	5	6,3	8	10
B	mm	7	8,5	10	13
C	mm	148	184,5	222	306,5
D	mm	19	25	30	38

## TAILSTOCK WITH EXTENDED TIP LIVE CENTER WITH COPYING CENTER

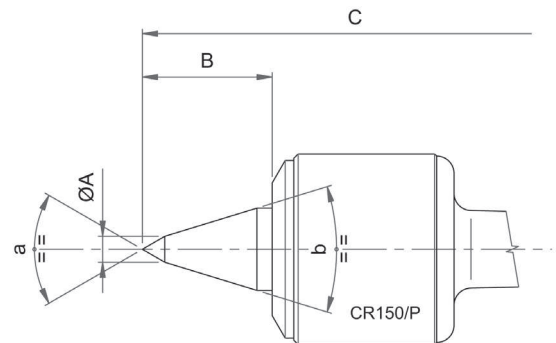

ARTICOLO - ORDER CODE		240/3/P	240/4/P	240/5/P	240/6/P
MODELLO - TYPE		CR150/3/P	CR150/4/P	CR150/5/P	CR150/6/P
CONO MORSE - MORSE TAPER		3	4	5	6
MAX ECCENTRICITA' - MAX RUNOUT	mm	0,005	0,005	0,005	0,005
PESO MAX PEZZO - COMPONENT MAX WEIGHT	Kg	70	150	300	600
SPINTA ASSIALE MAX - MAX AXIAL WEIGHT	Kg	400	700	1000	1500
a		60°	60°	60°	60°
b		34°	28°	36°	36°
A	mm	6	8	10	15
B	mm	30	39	40	64
C	mm	159	199,5	234	330,5



# TAILSTOCK WITH CARBIDE TIP DIN 8012

## LIVE CENTER WITH CARBIDE TIPPED - DIN 8012

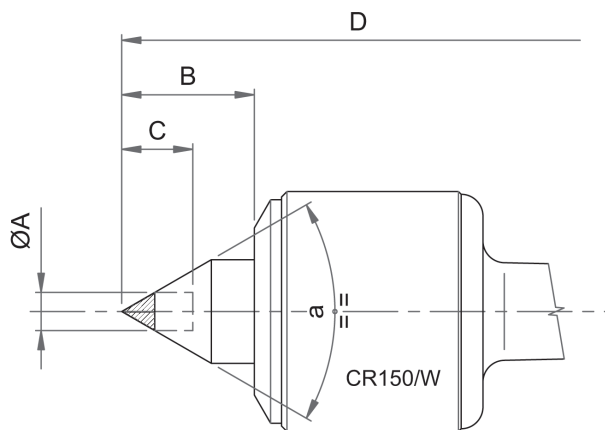

ARTICOLO - ORDER CODE		240/3/W	240/4/W	240/5/W	240/6/W
MODELLO - TYPE		CR150/3/W	CR150/4/W	CR150/5/W	CR150/6/W
CONO MORSE - MORSE TAPER		3	4	5	6
MAX ECCENTRICITA' - MAX RUNOUT	mm	0,004	0,004	0,004	0,004
PESO MAX PEZZO - COMPONENT MAX WEIGHT	Kg	60	150	280	500
SPINTA ASSIALE MAX - MAX AXIAL WEIGHT	Kg	320	500	800	1200
a		60°	60°	60°	60°
A	mm	10	12	14	18
B	mm	19	25	30	38
C	mm	20	22	25	32
D	mm	148	184,5	222	306,5

# BEARING LIFE CHART

## THEORETICAL BEARINGS LIFE DIAGRAM

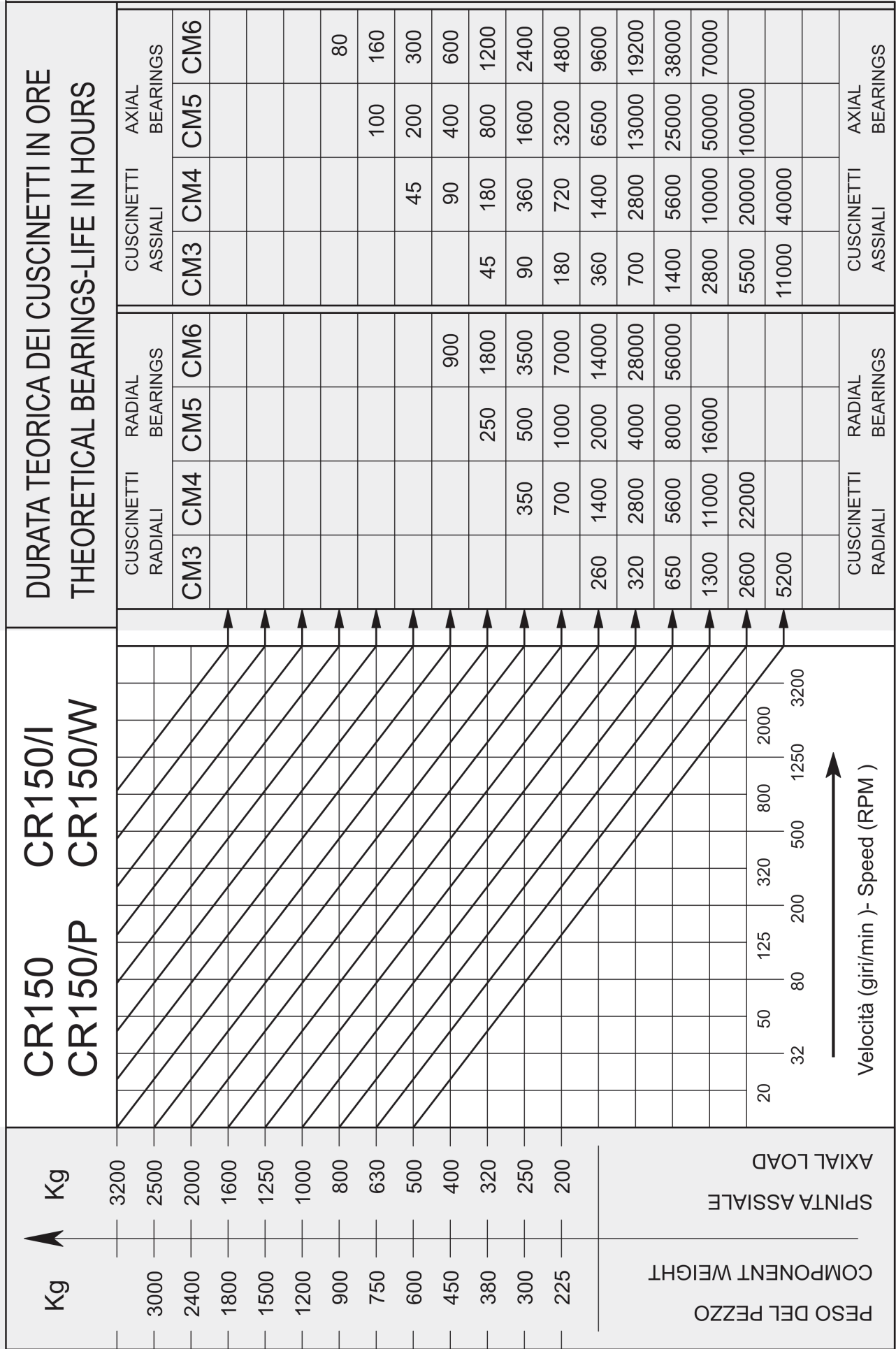



## TAILSTOCK WITH NORMAL TIP LIVE CENTER WITH STANDARD CENTER

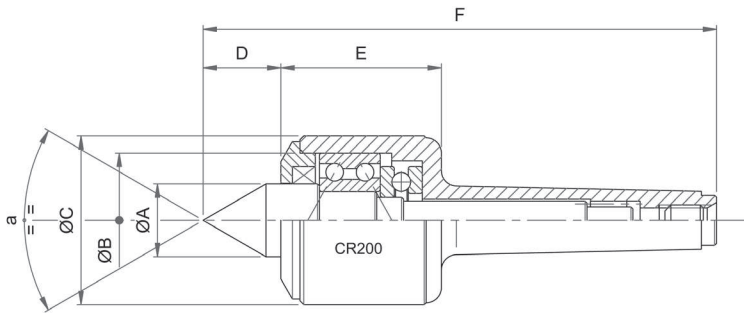

ARTICOLO - ORDER CODE		178/1	178/2	178/3	178/4	178/5	178/6
MODELLO - TYPE		CR200/1	CR200/2	CR200/3	CR200/4	CR200/5	CR200/6
CONO MORSE - MORSE TAPER		1	2	3	4	5	6
MAX ECCENTRICITA' - MAX RUNOUT	mm	0,005	0,005	0,005	0,005	0,005	0,01
PESO MAX PEZZO - COMPONENT MAX WEIGHT	Kg	50	100	250	500	1000	3000
SPINTA ASSIALE MAX - MAX AXIAL WEIGHT	Kg	150	400	700	1000	1500	3000
PESO CONTROPUNTA - LIVE CENTER WEIGHT	Kg	0,4	0,5	1,1	1,9	4,2	14
a		60°	60°	60°	60°	60°	60°+90°
A	mm	14	20	25	32	43	69
B	mm	28	35	47	52	72	110
C	mm	34	44	58	62	88	136
D	mm	21	19	25	30	38	66
E	mm	41	43	55	56	71	104
F	mm	122	135	161	195	247	367

## TAILSTOCK WITH FEMALE CENTER DIN 332-60° LIVE CENTER WITH HOLLOW-POINT DIN 332-60°

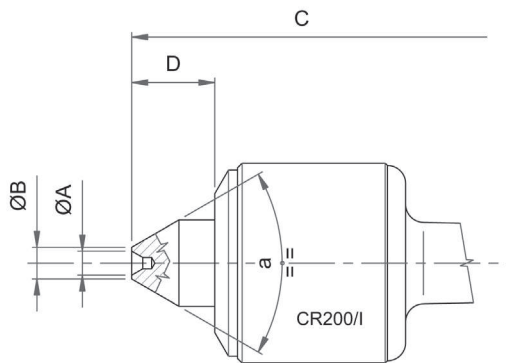

ARTICOLO - ORDER CODE		178/2/I	178/3/I	178/4/I	178/5/I
MODELLO - TYPE		CR200/2/I	CR200/3/I	CR200/4/I	CR200/5/I
CONO MORSE - MORSE TAPER		2	3	4	5
MAX ECCENTRICITA' - MAX RUNOUT	mm	0,005	0,005	0,005	0,005
PESO MAX PEZZO - COMPONENT MAX WEIGHT	Kg	80	200	400	800
SPINTA ASSIALE MAX - MAX AXIAL WEIGHT	Kg	400	700	1000	1500
a		60°	60°	60°	60°
A	mm	5	6,3	8	10
B	mm	7	8,5	10	13
C	mm	135	161	195	247
D	mm	19	25	30	38

## TAILSTOCK WITH EXTENDED TIP LIVE CENTER WITH COPYING CENTER

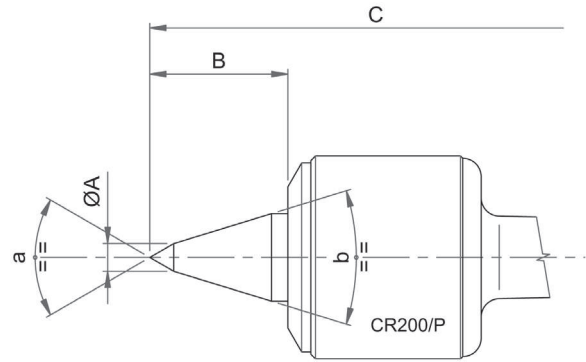

ARTICOLO - ORDER CODE		178/2/P	178/3/P	178/4/P	178/5/P
MODELLO - TYPE		CR200/2/P	CR200/3/P	CR200/4/P	CR200/5/P
CONO MORSE - MORSE TAPER		2	3	4	5
MAX ECCENTRICITA' - MAX RUNOUT	mm	0,005	0,005	0,005	0,005
PESO MAX PEZZO - COMPONENT MAX WEIGHT	Kg	70	150	300	600
SPINTA ASSIALE MAX - MAX AXIAL WEIGHT	Kg	400	700	1000	1500
a		60°	60°	60°	60°
b		34°	28°	36°	36°
A	mm	6	8	10	15
B	mm	30	39	40	64
C	mm	146	176	207	271

## TAILSTOCK WITH METAL TIP LIVE CENTER WITH COPYING CENTER

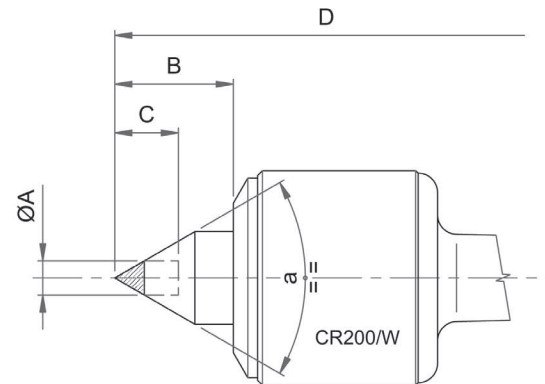

ARTICOLO - ORDER CODE		178/2/W	178/3/W	178/4/W	178/5/W
MODELLO - TYPE		CR200/2/W	CR200/3/W	CR200/4/W	CR200/5/W
CONO MORSE - MORSE TAPER		2	3	4	5
MAX ECCENTRICITA' - MAX RUNOUT	mm	0,004	0,004	0,004	0,004
PESO MAX PEZZO - COMPONENT MAX WEIGHT	Kg	60	150	280	500
SPINTA ASSIALE MAX - MAX AXIAL WEIGHT	Kg	320	500	800	1200
a		60°	60°	60°	60°
A	mm	10	12	14	18
B	mm	19	25	30	38
C	mm	20	22	25	32
D	mm	135	161	195	247



# BEARING LIFE CHART

## THEORETICAL BEARINGS LIFE DIAGRAM

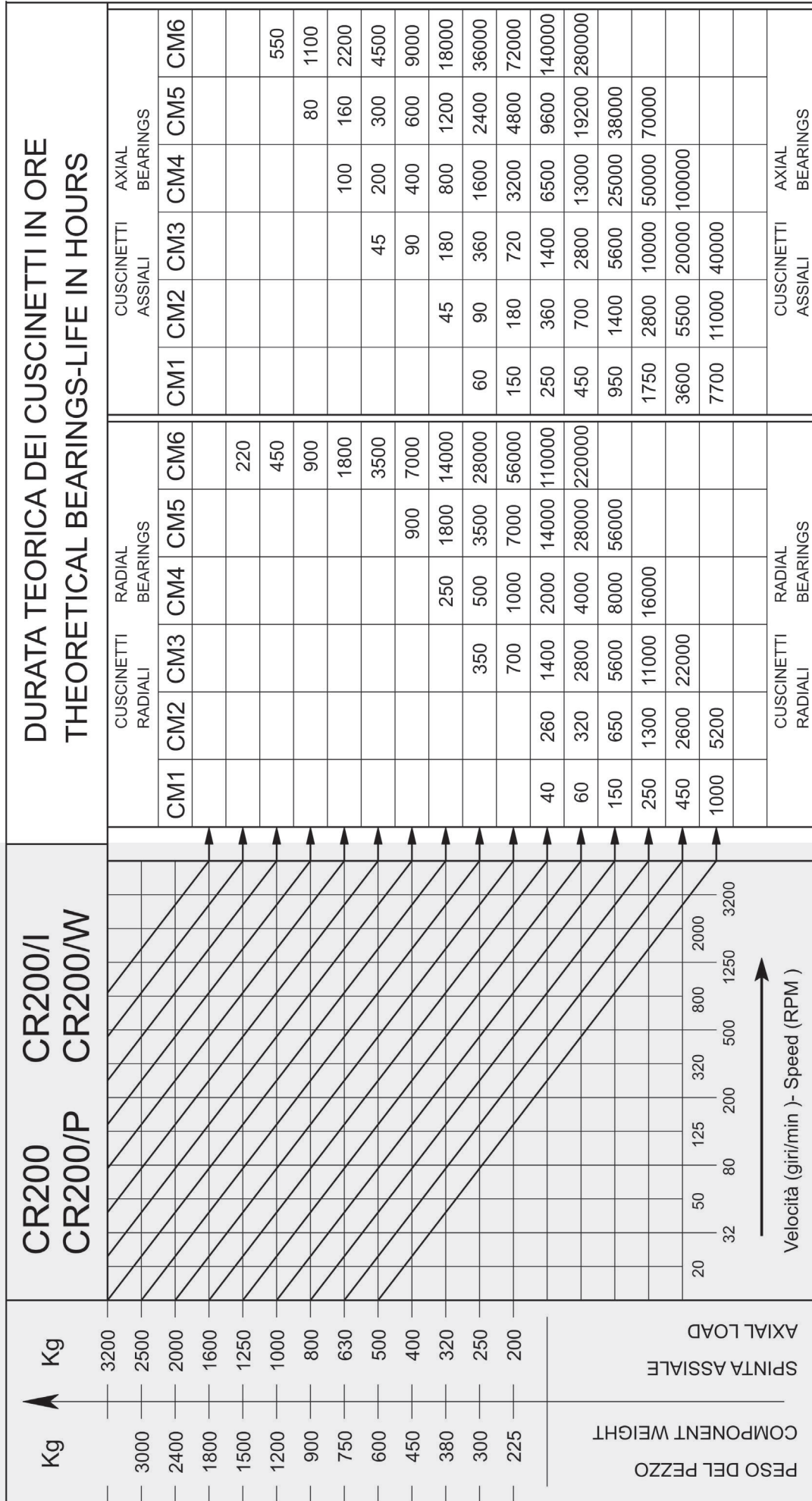



# TAILSTOCK WITH EXTENDED TIP LIVE CENTER WITH COPYING CENTER

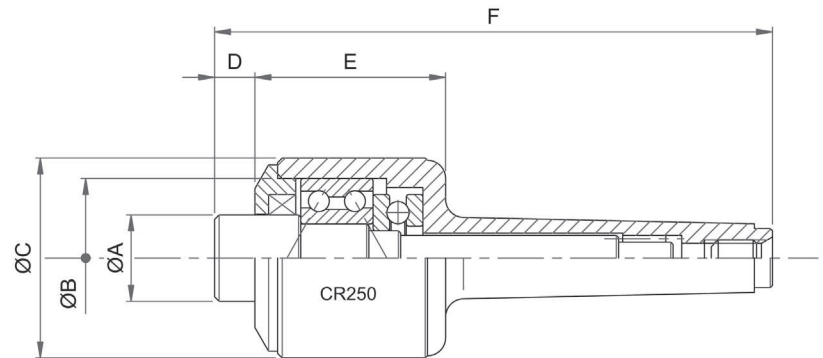

ARTICOLO - ORDER CODE		190/3	190/4	190/5
MODELLO - TYPE		CR250/3	CR250/4	CR250/5
CONO MORSE - MORSE TAPER		3	4	5
MAX ECCENTRICITA' - MAX RUNOUT	mm	0,005	0,005	0,005
PESO MAX PEZZO - COMPONENT MAX WEIGHT	Kg	300	300	300
SPINTA ASSIALE MAX - MAX AXIAL WEIGHT	Kg	1000	1000	1000
PESO CONTROPUNTA - LIVE CENTER WEIGHT	Kg	1,3	1,7	2,5
A	mm	32	32	32
B	mm	52	52	52
C	mm	62	62	62
D	mm	10	10	10
E	mm	56	56	56
F	mm	155	176	203

## BITS WITH CONICAL SHANK CENTERING POINTS WITH CONNECTING CONE

Art.195

Art.194

Art.193

Art.196

Art.192

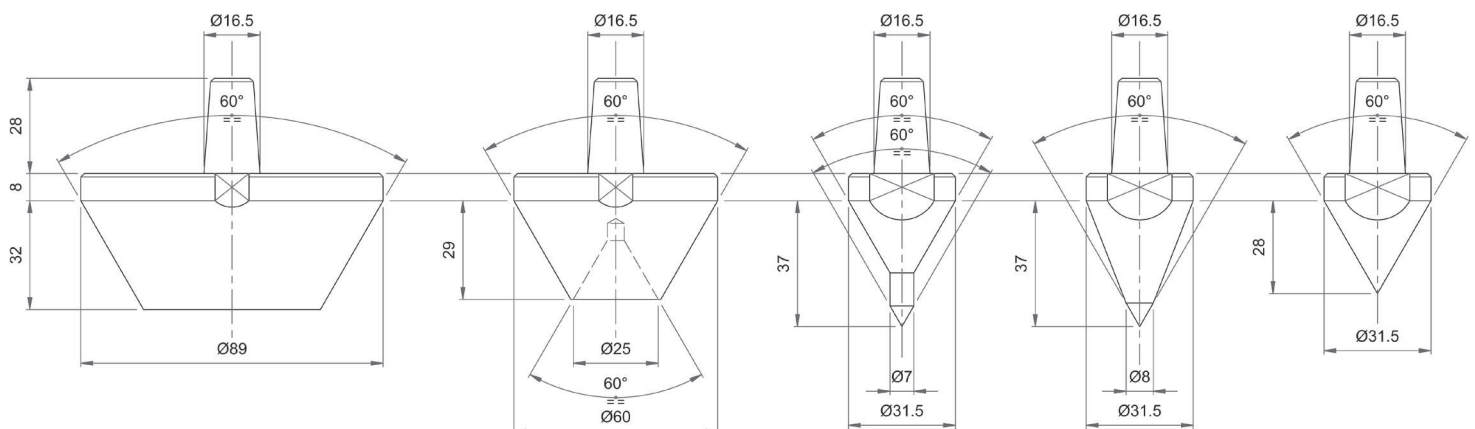



# BEARING LIFE CHART

## THEORETICAL BEARINGS LIFE DIAGRAM

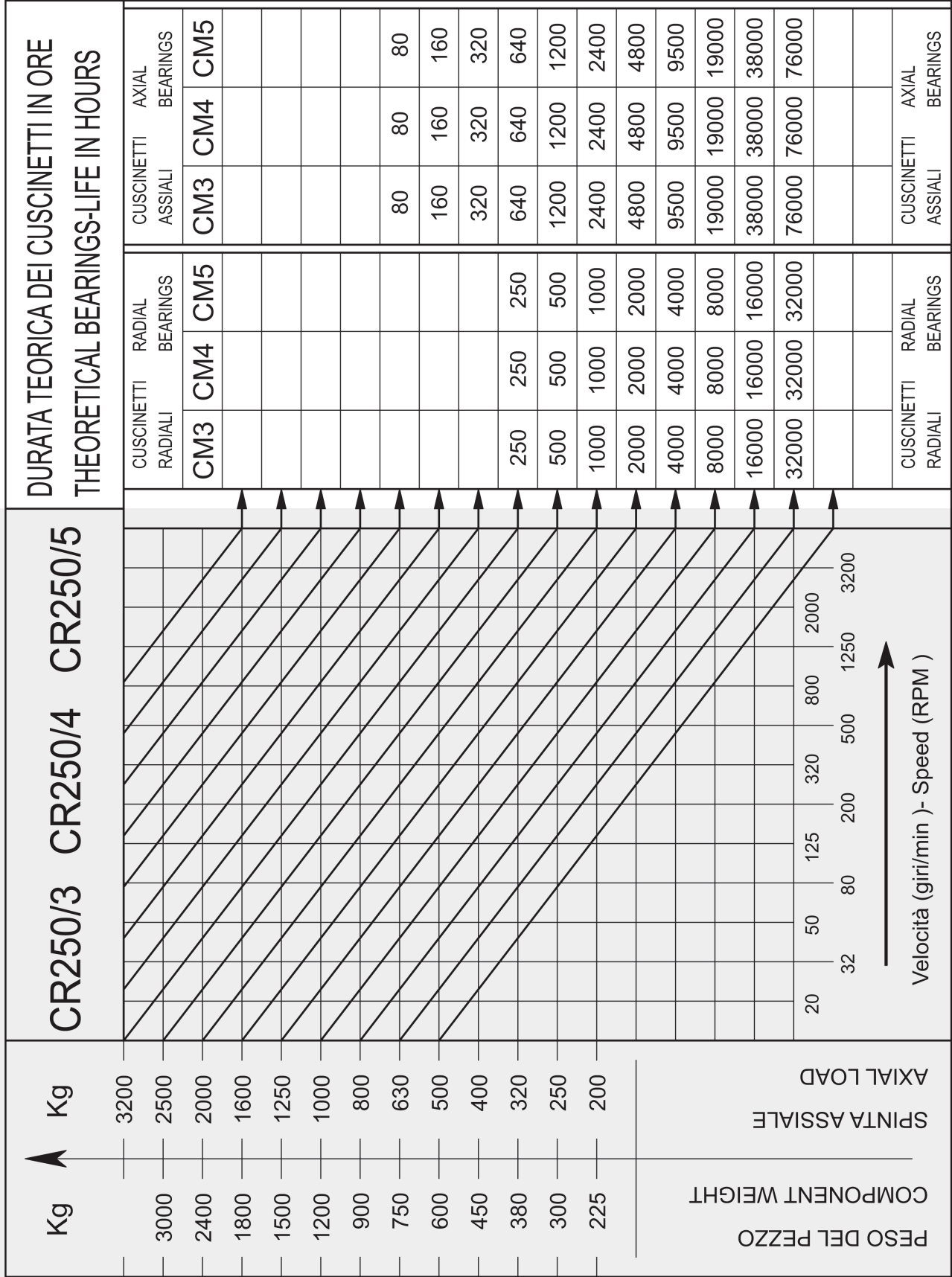

# ROTATING TAILSTOCKS WITH EXTRACTION NUT LIVE CENTERS WITH RING-NUT EXTRACTION

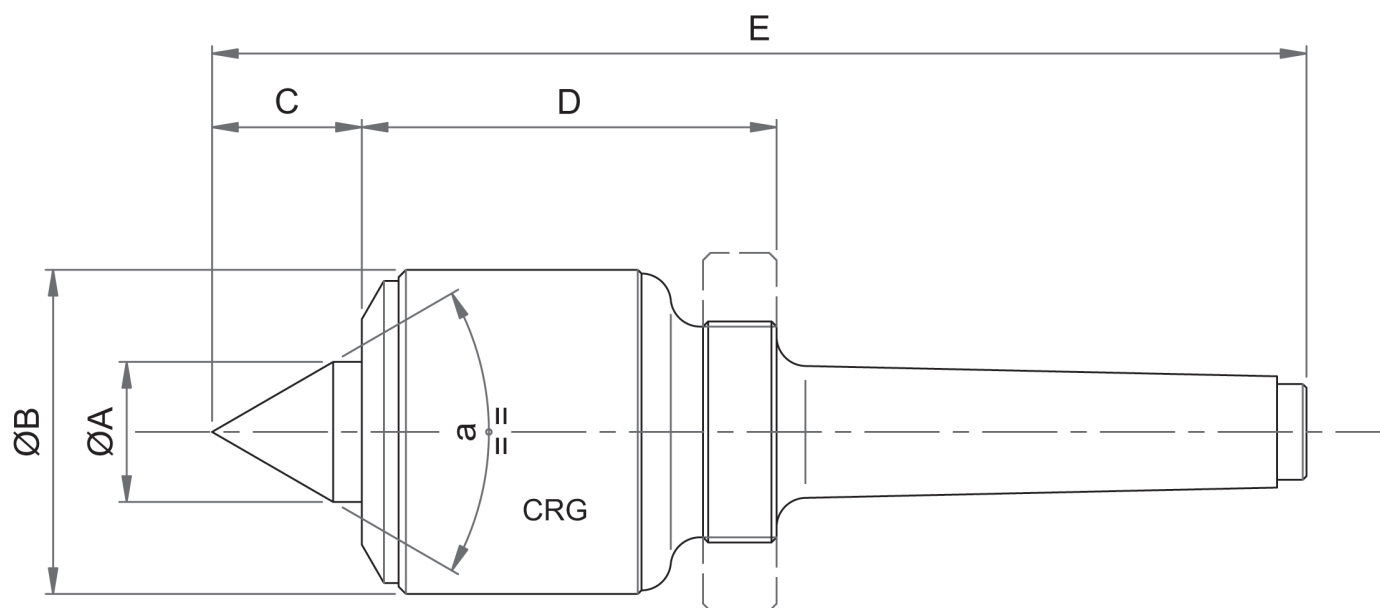

ARTICOLO - ORDER CODE		240/5/G	178/4/G	190/4/G	190/5/G
MODELLO - TYPE		CRG150/5	CRG200/4	CRG250/4	CRG250/5
CONO MORSE - MORSE TAPER		5	4	4	5
MAX ECCENTRICITA' - MAX RUNOUT	mm	0,005	0,005	0,005	0,005
PESO MAX PEZZO - COMPONENT MAX WEIGHT	Kg	500	500	300	300
SPINTA ASSIALE MAX - MAX AXIAL WEIGHT	Kg	1000	1000	1000	1000
PESO CONTROPUNTA - LIVE CENTER WEIGHT	Kg	2,0	2,0	1,8	2,6
GHIERA - RING NUT		M50x2	M40x2	M40x2	M50x2
a		60°	60°	-	-
A	mm	32	32	32	32
B	mm	62	62	62	62
C	mm	30	30	10	10
D	mm	72	70	70	72
E	mm	238	209	190	219

**NOTE:** for the sizing of the tailstock in its application, the life tables of the corresponding tailstocks apply (**EX.:** for CRG150/5 see CR150/5).

**NOTE:** to dimension the live center in the request application, use the tables of the theoretical bearing life about the corresponding live center (**EX.:** for CRG150/5 compare CR150/5).

# SPECIAL FIXED TAILSTOCKS FIXED SPECIAL LIVE CENTERS

Below we show some examples of special fixed tailstocks which **OMCA** builds on customer request based on the application.

They can be built entirely in steel or with a carbide tip, and divided into fixed tailstocks for lathes, normal for grinding, extended tailstocks, with double inclination, with internal center or with cylindrical shank.

As below are showed any examples of fixed live centers that **OMCA** manufactured on customer's application request.

Could be manufactured completely in steel or with carbide tipped, and shared in live centers for lathe, normal for grinding, extended, with two inclinations, with internal center or with cylindrical shaft.

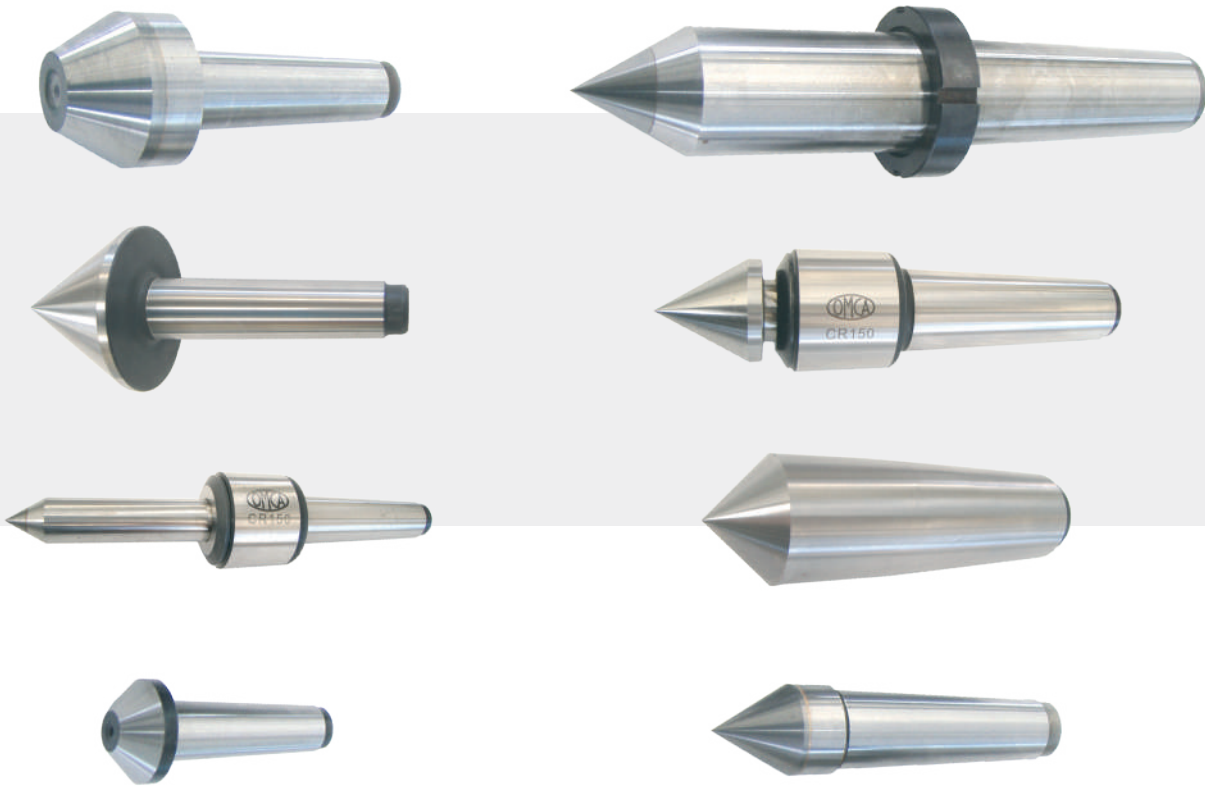

Example of special tailstock requested by the customer:

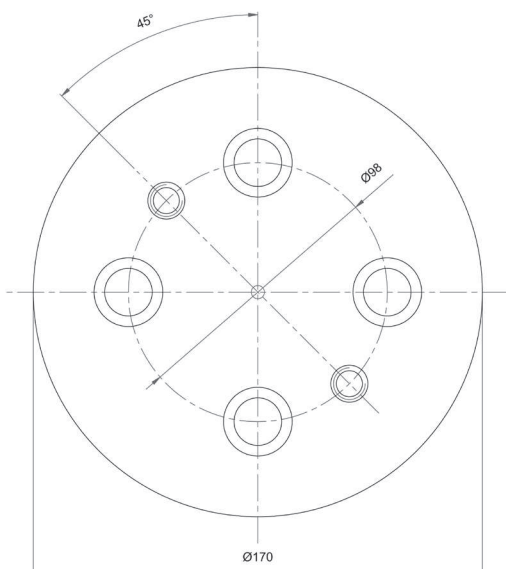

Example of special center requested by Customer:

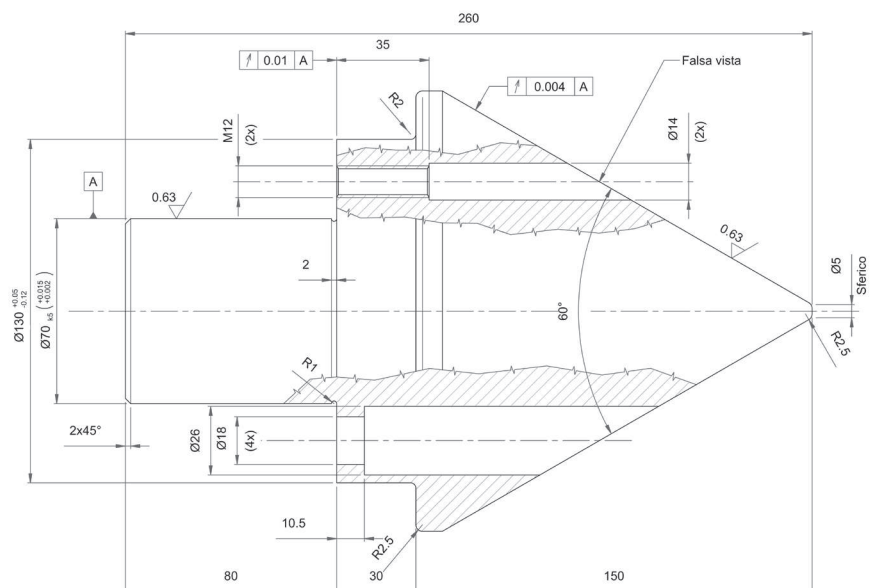

По вопросам продаж и поддержки обращайтесь:

**Алматы** (7273)495-231  
**Ангарск** (3955)60-70-56  
**Архангельск** (8182)63-90-72  
**Астрахань** (8512)99-46-04  
**Барнаул** (3852)73-04-60  
**Белгород** (4722)40-23-64  
**Благовещенск** (4162)22-76-07  
**Брянск** (4832)59-03-52  
**Владивосток** (423)249-28-31  
**Владикавказ** (8672)28-90-48  
**Владимир** (4922)49-43-18  
**Волгоград** (844)278-03-48  
**Вологда** (8172)26-41-59  
**Воронеж** (473)204-51-73  
**Екатеринбург** (343)384-55-89  
**Иваново** (4932)77-34-06  
**Ижевск** (3412)26-03-58  
**Иркутск** (395)279-98-46  
**Казань** (843)206-01-48

**Калининград** (4012)72-03-81  
**Калуга** (4842)92-23-67  
**Кемерово** (3842)65-04-62  
**Киров** (8332)68-02-04  
**Коломна** (4966)23-41-49  
**Кострома** (4942)77-07-48  
**Краснодар** (861)203-40-90  
**Красноярск** (391)204-63-61  
**Курган** (3522)50-90-47  
**Курск** (4712)77-13-04  
**Липецк** (4742)52-20-81  
**Магнитогорск** (3519)55-03-13  
**Москва** (495)268-04-70  
**Мурманск** (8152)59-64-93  
**Набережные Челны** (8552)20-53-41  
**Нижний Новгород** (831)429-08-12  
**Новокузнецк** (3843)20-46-81  
**Новосибирск** (383)227-86-73  
**Ноябрьск**(3496)41-32-12

**Омск** (3812)21-46-40  
**Орел** (4862)44-53-42  
**Оренбург** (3532)37-68-04  
**Пенза** (8412)22-31-16  
**Пермь** (342)205-81-47  
**Петрозаводск** (8142)55-98-37  
**Псков** (8112)59-10-37  
**Ростов-на-Дону** (863)308-18-15  
**Рязань** (4912)46-61-64  
**Самара** (846)206-03-16  
**Санкт-Петербург** (812)309-46-40  
**Саранск** (8342)22-96-24  
**Саратов** (845)249-38-78  
**Севастополь** (8692)22-31-93  
**Симферополь** (3652)67-13-56  
**Смоленск** (4812)29-41-54  
**Сочи** (862)225-72-31  
**Ставрополь** (8652)20-65-13  
**Сургут** (3462)77-98-35

**Сыктывкар** (8212)25-95-17  
**Тамбов** (4752)50-40-97  
**Тверь** (4822)63-31-35  
**Тольятти** (8482)63-91-07  
**Томск** (3822)98-41-53  
**Тула** (4872)33-79-87  
**Тюмень** (3452)66-21-18  
**Улан-Удэ** (3012)59-97-51  
**Ульяновск** (8422)24-23-59  
**Уфа** (347)229-48-12  
**Хабаровск** (4212)92-98-04  
**Чебоксары** (8352)28-53-07  
**Челябинск** (351)202-03-61  
**Череповец** (8202)49-02-64  
**Чита** (3022)38-34-83  
**Якутск** (4112)23-90-97  
**Ярославль** (4852)69-52-93

**Россия** +7(495)268-04-70

**Казахстан** +7(7172)727-132

**Киргизия** +996(312)96-26-47

**ocm@nt-rt.ru || www.omca.nt-rt.ru**